



Car Air Purifier

Instruction Manual



P1

Important Notice

 <p>Don't use any liquid like water, or cleaner to clean it.</p>	 <p>Don't cover anything on it.</p>
 <p>Please use it carefully in case of dropping.</p>	 <p>This is not a toy in case of damage.</p>
 <p>Please cut off the power during cleaning or fixing. Please use the soft cloth only for cleaning.</p>	 <p>Don't operate it during driving.</p>

P2

Product Introduction

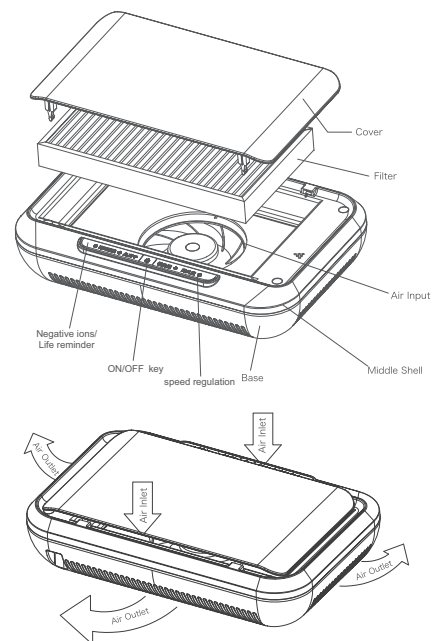

P3

Part List



Car Charger

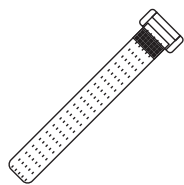

Strap

1. Please install it according to the instruction.
2. Please use the parts in this box only for installing.

Application

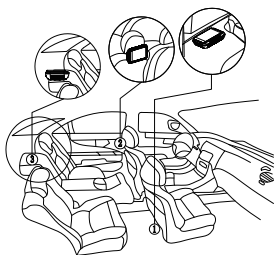

It can be installed in different location per different cars:
 eg: 1. Under the front seat.
 2. Behind of the backing of front seat.
 3. On the back seat.

P4

Install it behind the backing of seats

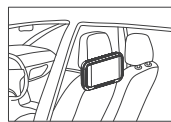

Install it behind the backing of seats per different cars.

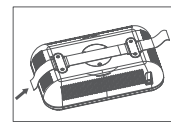

Please insert the strap through the 2 holders like the above picture.

Using Instruction

To install the Filter

1. Please cut off the power before installing.
2. Take off the polybag from the filter.
3. Make sure the Filter is in right direction.

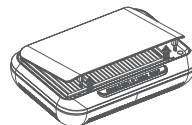

Take off the cover as arrow shows.

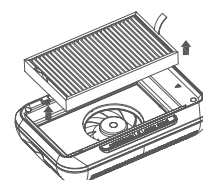

Take off the filter as arrow shows.

P5

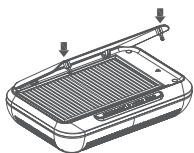

Insert in the cover and press it well.

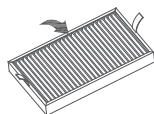

The Direction of the filter

Attention: The Purifier will not work if the cover has been taken off or Not been covered well.

Product Parameter

Model Number	Car Air Purifier	CADR	23.5cfm
Rated Voltage	DC12V	Air purification	efficiency grade
Rated Power	8.5W	Application	in Car
Noise	50dB(A)	Size	279.5mm×179.5mm×73.2mm

MADE IN CHINA



Control Panel Operation



Touch key operation :

1. After power on, the button will flash and the machine is in standby state.
2. Touch the switch button and the machine will enter the working state at fan speed 1. Touch the fan icon lightly to adjust to the desired speed.
3. The negative ion function will be turned off by default when the machine is turned on. Touch the negative ion button, and the white light at the bottom will show the negative ion is on. The anion button shows filter life. When the filter expires, the red light at the bottom of the button flashes. After replacing the filter, long press the button for 3 seconds, which will turn off the red light, and reset the filter indicator.

P6

P7