

# INSTALLATION MANUAL

---

## Decoration panel

---

MODEL

**BYFQ60C3W2W**

English

Français

Español

Read these instructions carefully before installation.  
Keep this manual in a handy place for future reference.  
This manual should be left with the equipment owner.

Lire soigneusement ces instructions avant l'installation.  
Conserver ce manuel à portée de main pour référence ultérieure.  
Ce manuel doit être donné au propriétaire de l'équipement.

Lea cuidadosamente estas instrucciones antes de instalar.  
Guarde este manual en un lugar a mano para leer en caso de tener alguna duda.  
Este manual debe permanecer con el propietario del equipo.

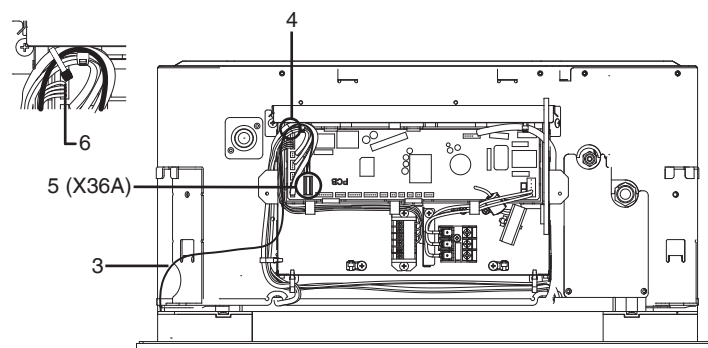
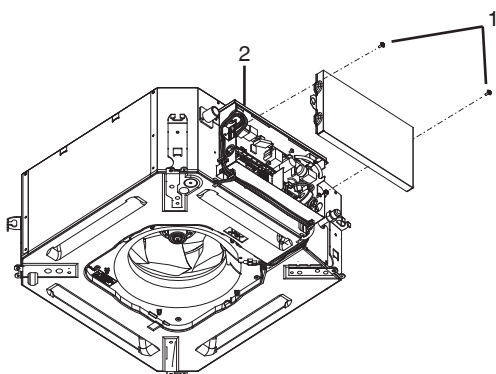
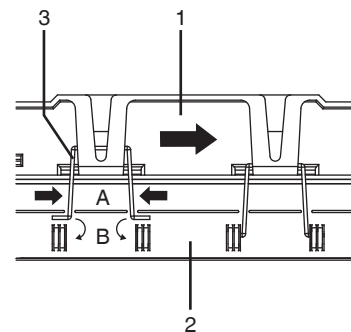
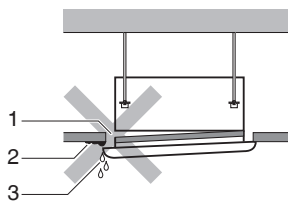
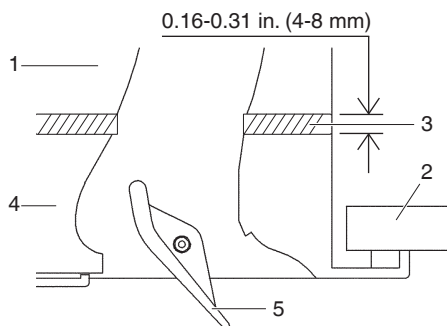
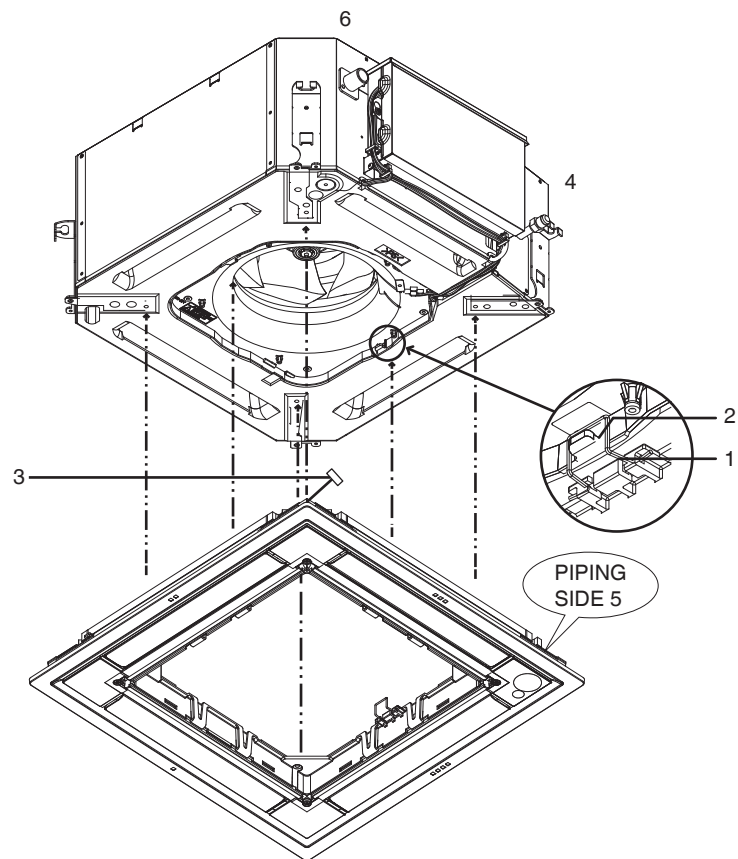
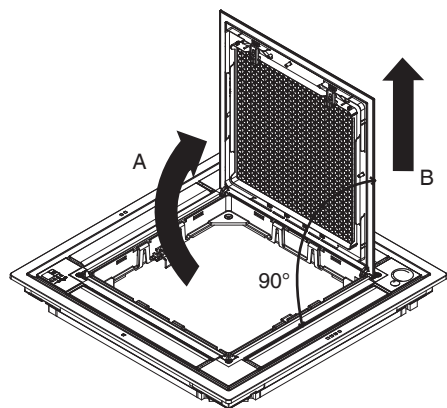
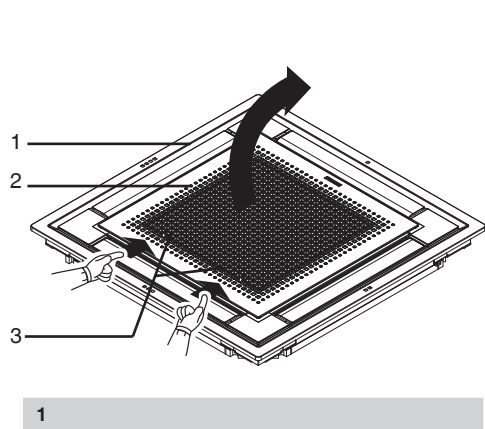



The English text is the original instruction. Other languages are translations of the original instructions.

Read this manual attentively before installation. Do not throw it away. Keep it in your files for future reference.

Improper installation or attachment of equipment or accessories could result in electric shock, short-circuit, leak, fire or other damage to the equipment. Be sure only to use accessories made by Daikin that are specifically designed for the use with the equipment and have them installed by a professional.

If unsure of installation procedures or use, always contact your dealer for advice and information.

## Before installation

- Leave the unit inside its packaging until you reach the installation site.



**Rotary fan**



Cut off the main power supply before opening the grille.

- Refer to the installation manual of the indoor unit for items not described in this manual.

### NOTE



### To the installer

Be sure to instruct the customer how to properly operate the system showing him or her the operation manual of the indoor unit.

## Accessories

Installation manual	
Screws (4 pcs.)	
Suction grille hinge (2 pcs.)	

## Preparation before installation

For this unit, you are able to select airflow directions. To discharge air in 2 or 3 directions, it is necessary to purchase the optional sealing member of air discharge outlet for sealing air outlets.

### Handling of the decoration panel

To prevent any damage to the decoration panel, take care of the following:

- Never place the decoration panel facing down.
- Never let the decoration panel lean against a wall.
- Never place the decoration panel on a sharp or projecting object.
- Never touch or put pressure on the horizontal blade in order to prevent malfunction of the horizontal blade.

## Preparing the decoration panel for installation

- 1 Remove the suction grille from the decoration panel.

- 1 Decoration panel
- 2 Suction grille
- 3 Knob

- Remove the packing tape from the suction grille and horizontal blades.

- Push the knobs inward and open the suction grille. (See figure 1)

- Detach the suction grille from the decoration panel by lifting the suction grille up approximately 90 degrees (A) until the position is reached on which removal of the suction grille is possible (B). (See figure 2)

## Installation of the decoration panel to the indoor unit

Refer to the installation manual of the indoor unit for details on installing the indoor unit.

- 1 Install the decoration panel (See figure 3)

- 1 Temporary latch
- 2 Hook
- 3 Horizontal blade motor lead wire
- 4 Piping area
- 5 Piping side mark
- 6 Drain area

- 1 Hold the decoration panel against the indoor unit by matching the piping side mark on the decoration panel with the position of the piping area of the indoor unit.
- 2 Turn 2 temporary latches up into the hooks of the indoor unit so the decoration panel is temporarily fixed to the indoor unit. (See figure 3)
- 3 Make sure that the horizontal blade motor lead wire is not caught between the decoration panel and the indoor unit.
- 4 Attach 4 supplied screws and check whether the decoration panel is properly aligned with the indoor unit and ceiling.
- 5 Tighten all 4 screws until the thickness between the decoration panel and the indoor unit reduces to 0.16-0.31 in. (4-8 mm). (See figure 4)

- 1 Indoor unit
- 2 Ceiling
- 3 Sealing material
- 4 Decoration panel
- 5 Horizontal blade

## Precautions

- Improper tightening of the screws - (See figure 5) - may cause air to leak into the unit and between the ceiling and the decoration panel (1), resulting in formation of contamination (2) and dew (3).
- If there is a gap remaining between the ceiling and the decoration panel after tightening the screws, re-adjust the indoor unit body height. The indoor unit must be kept leveled and the drain piping kept unaffected.

### 2 Wiring of the decoration panel (See figure 6)



Make sure to turn off the power supply before wiring!

- 1 Screws
  - 2 Control box
  - 3 Horizontal blade motor lead wire
  - 4 Horizontal blade motor lead wire fixed by clamp to the rest of the wires (See detail in figure 6)
  - 5 Connector of the indoor unit PCB (X36A)
  - 6 Clamp
- 1 Remove the control box cover. Loosen 2 screws and slide the control box cover downward.
  - 2 Securely connect the connector of horizontal blade motor lead wire installed on the decoration panel. Attach the horizontal blade motor lead wire to the rest of the wires firmly by clamp (from indoor unit accessory set). (See figure 6)
  - 3 Replace the control box cover reversing the procedure to remove it.



Make sure that the horizontal blade motor lead wire is not caught between the indoor unit and the decoration panel and between the control box and cover.

## Installation of the suction grille to decoration panel

Install the suction grille (See figure 7)

- 1 Decoration panel
- 2 Suction grille
- 3 Suction grille hinge (attached to decoration panel)

- 1 Remove the packing tape which is securing 2 suction grille hinges in place.
  - 2 Attach the suction grille to hinges by pressing the hinge and inserting both ends of hinge to holes on the suction grille. (See figure 7)
  - 3 Make sure that the suction grille is attached to the decoration panel properly by 2 hinges.
  - 4 Close the suction grille by reversing the procedure shown in "Preparing the decoration panel for installation" on page 1.
- The suction grille may be installed in 4 directions by simply turning it 90 degrees.
  - Change the direction when adjusting the direction of the suction grille of multiple units or to comply with the demands of the customer.

**DAIKIN MANUFACTURING COMPANY, L.P.**

Daikin Texas Technology Park,  
19001 Kermier Road,  
Waller, TX, 77484, U.S.A.

